







# Hillsdale Hospital Map

-  Elevator
-  Stairs
-  Nurses' Station
-  Dining Area
-  Waiting Room
-  Registration Desk
-  Vending



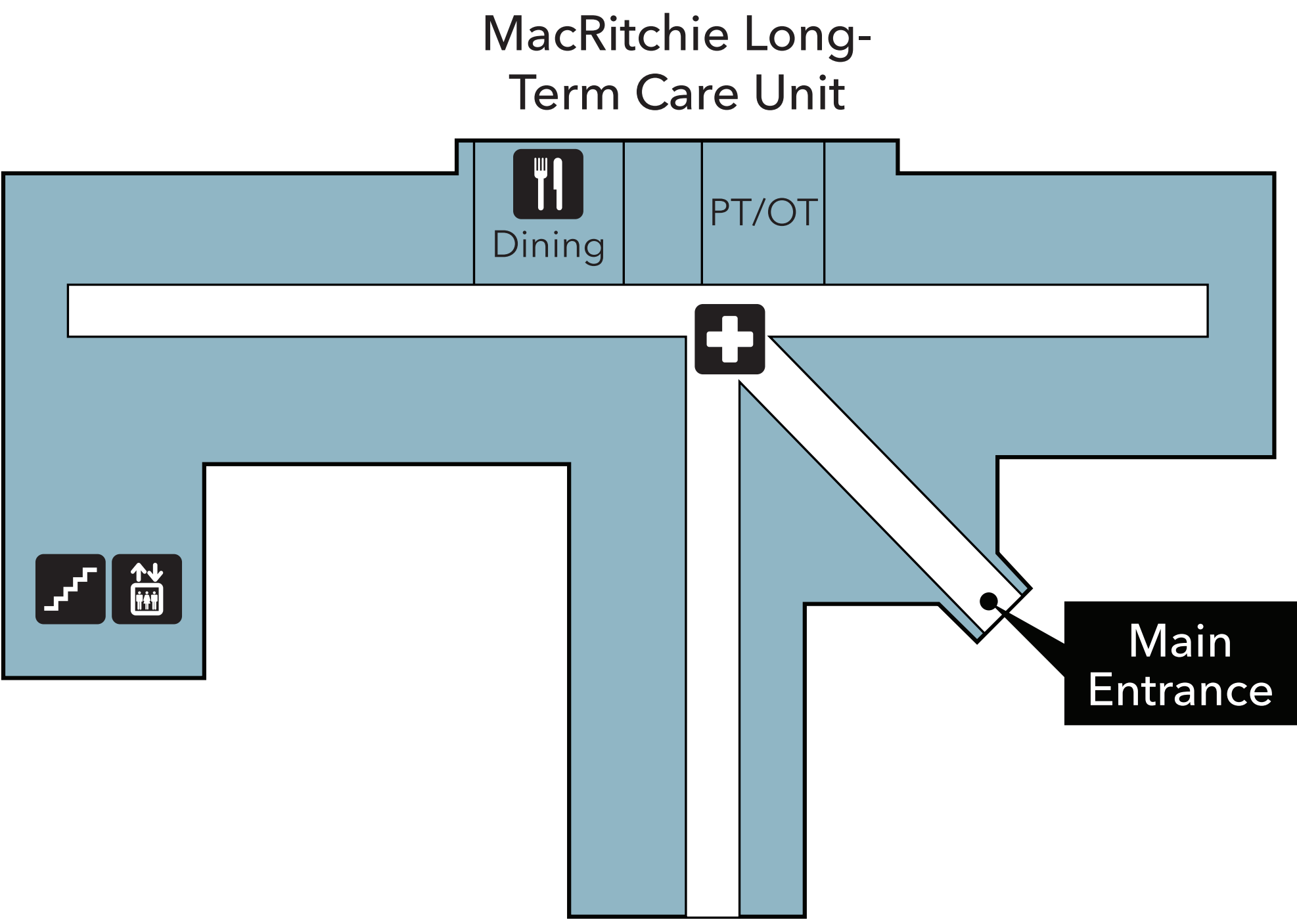
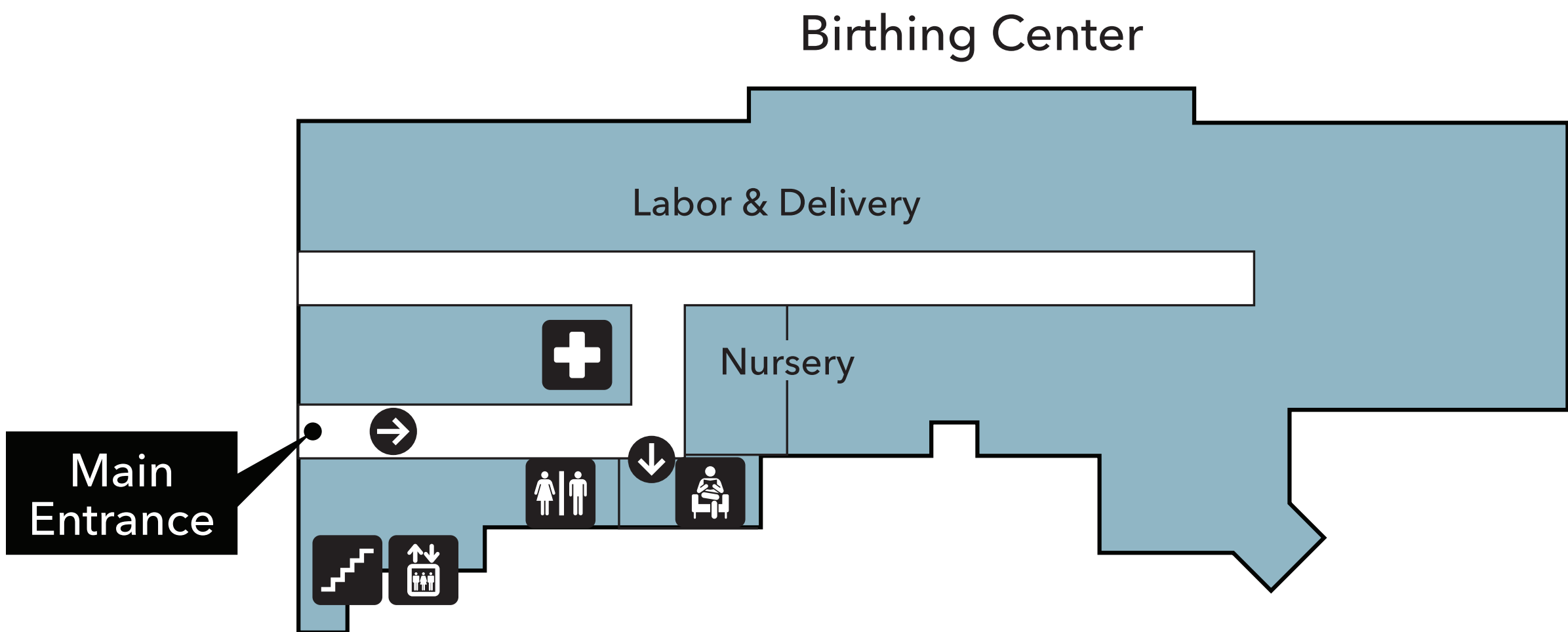
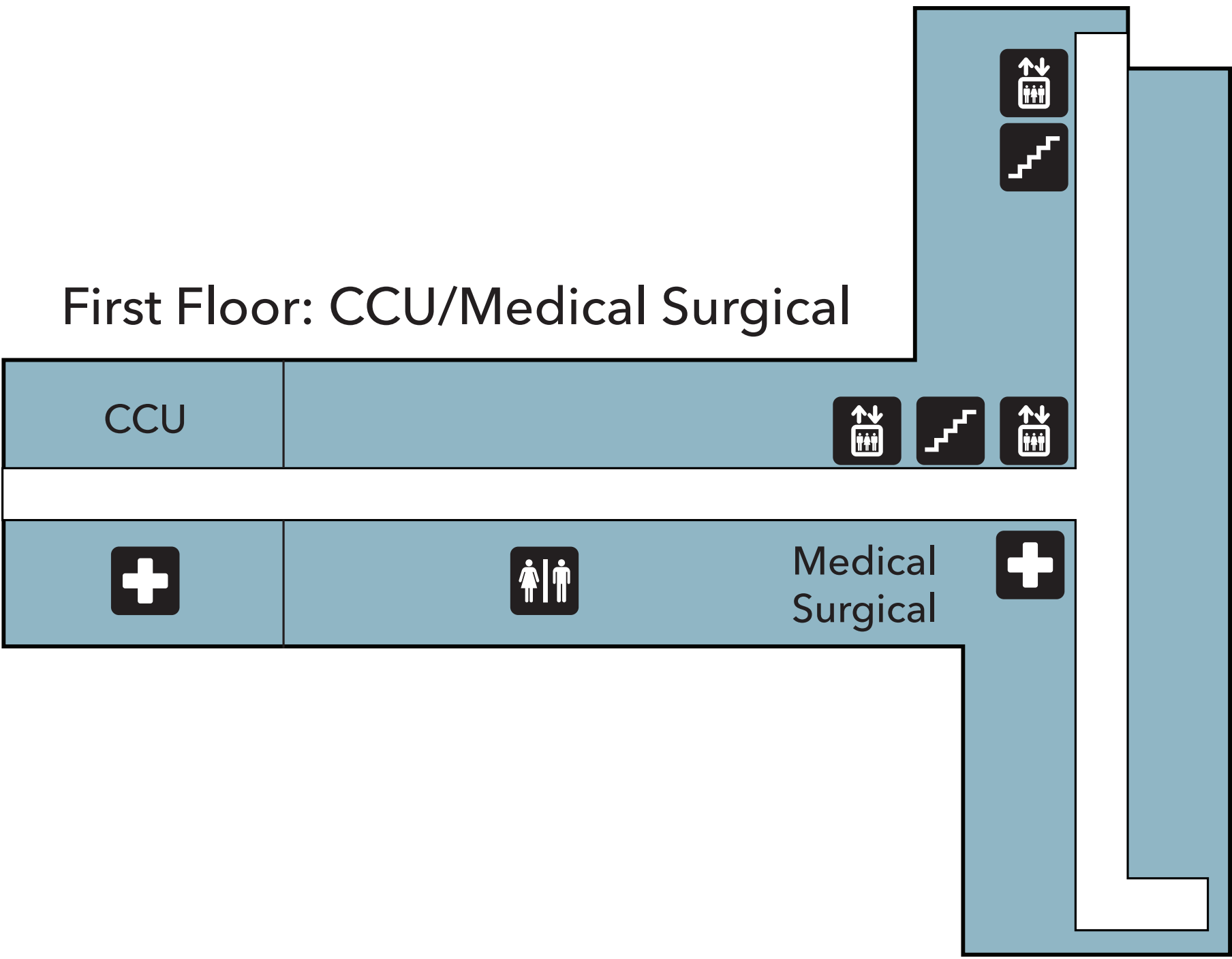
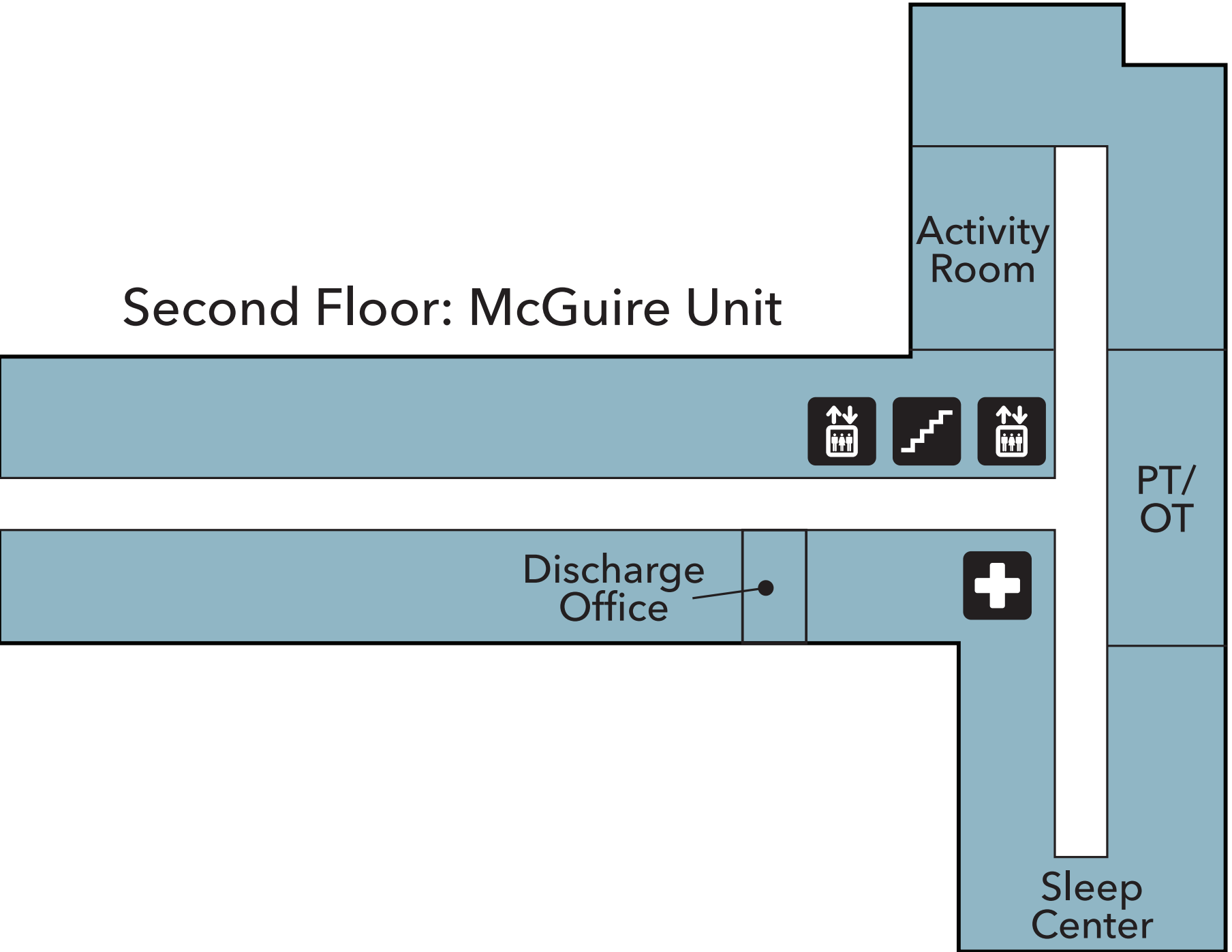
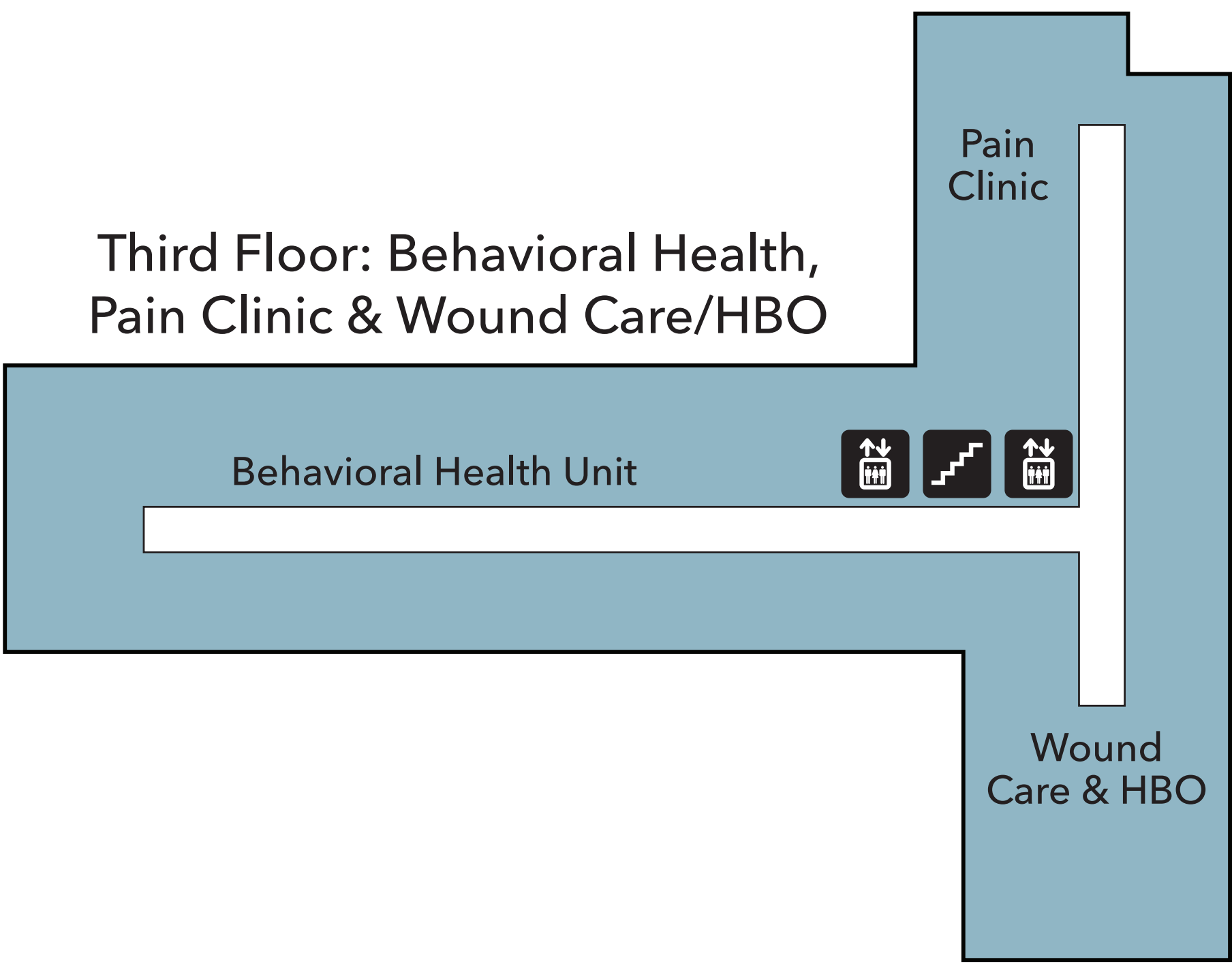
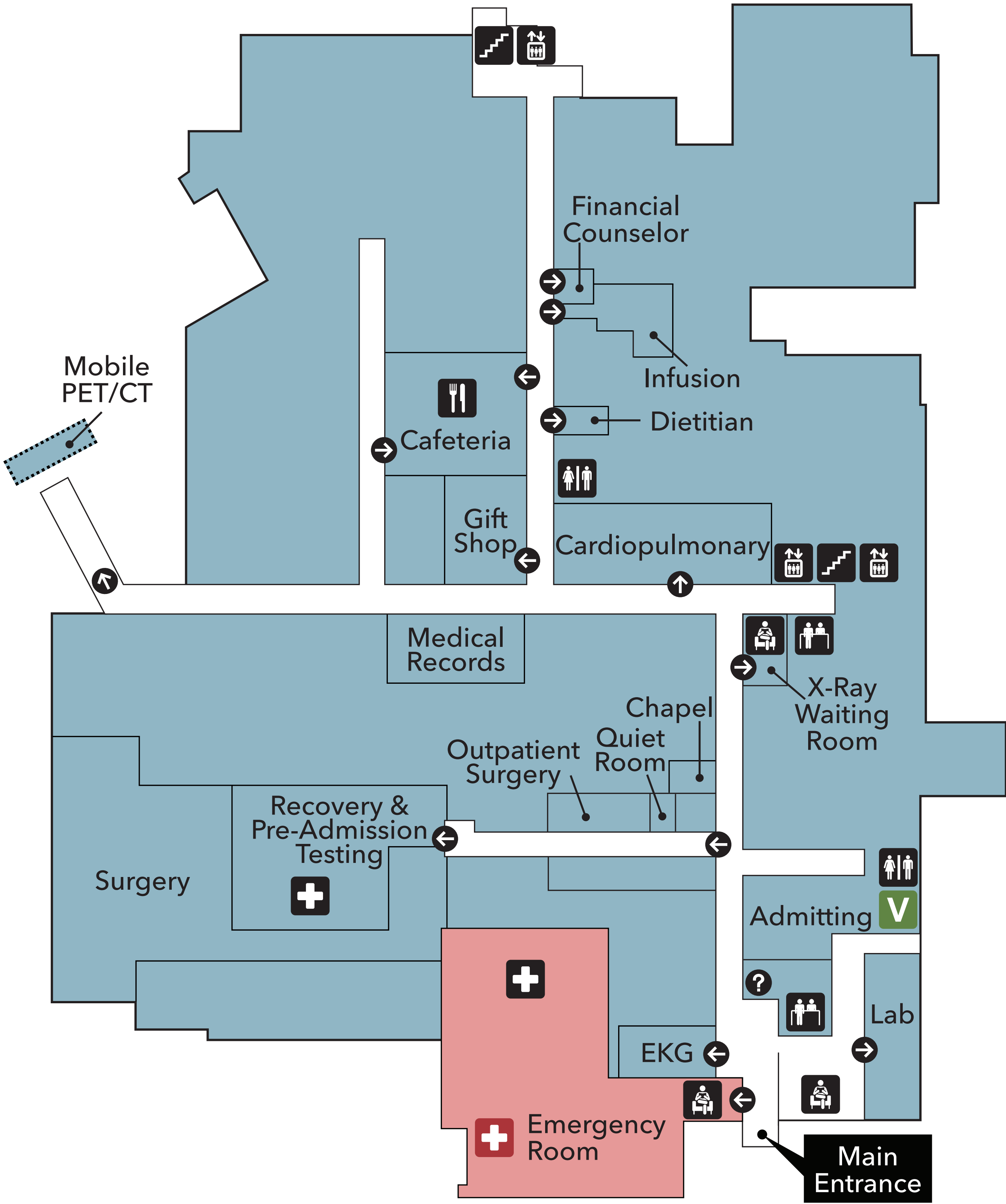
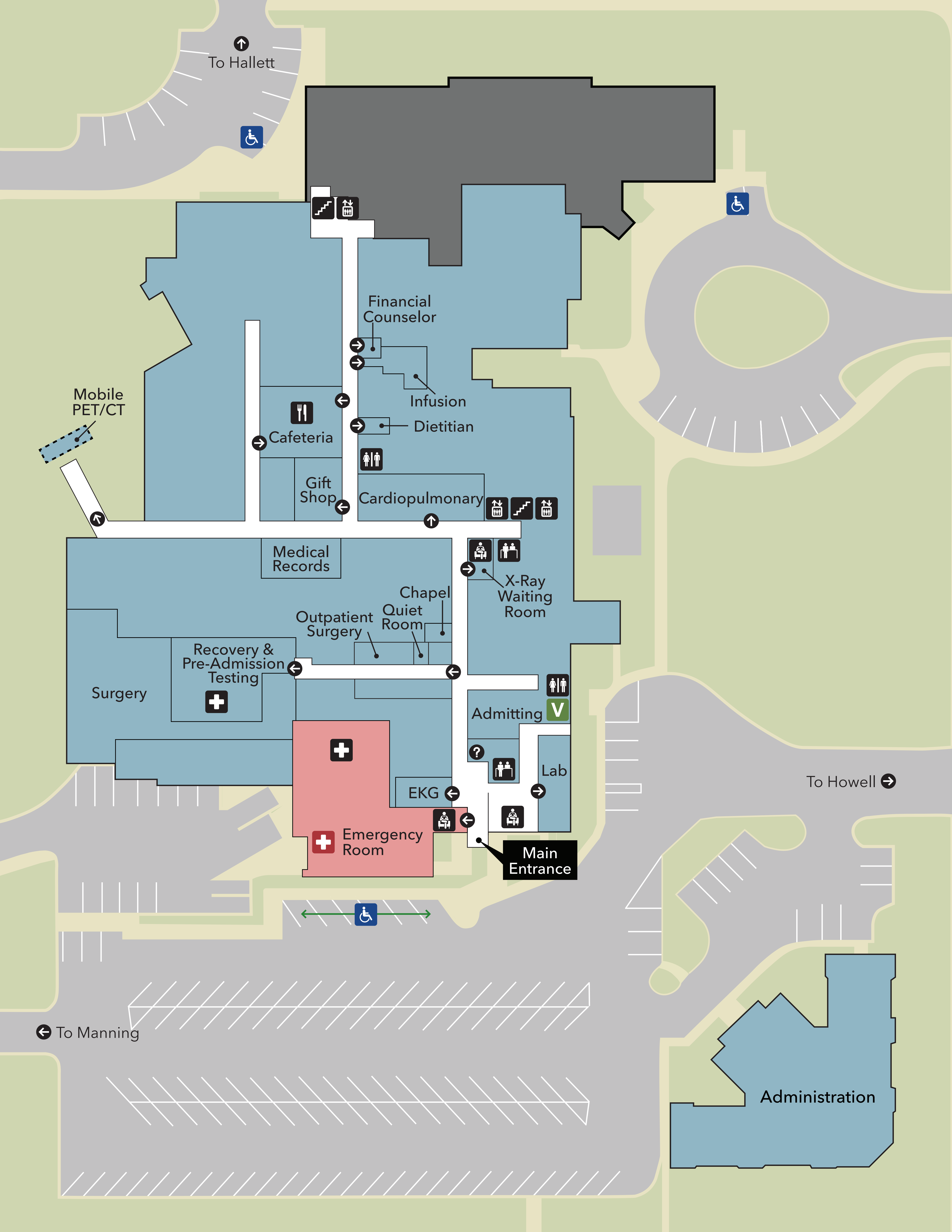

↑  
To Hallett



Mobile  
PET/CT

Financial  
Counselor

Infusion

Dietitian

Cafeteria

Gift  
Shop

Cardiopulmonary

Medical  
Records

Chapel

Outpatient  
Surgery

Recovery &  
Pre-Admission  
Testing

Surgery

X-Ray  
Waiting  
Room

Admitting

Lab

EKG

Emergency  
Room

Main  
Entrance

To Howell →

Administration

← To Manning